

Princess Drive  
, York  
YO26 5SY

Leasehold  
Council Tax Band - C

- Top Floor
- Generous Lounge
- Two Bedroom Apartment
- Modernised Throughout
- Allocated & Visitor Parking
- Sought After Development
- EPC - C

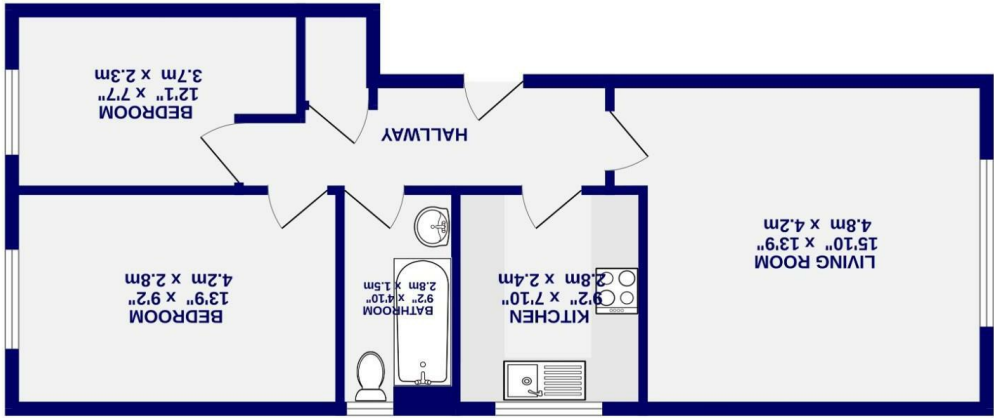

2ND FLOOR  
607 sq.ft. (56.4 sq.m.) approx.



These particulars have been prepared as accurately and as reliably as possible, but should not be relied upon as 'statement of fact'. If there is any point which is of particular importance to you, please contact the office and we would be pleased to check the information. We have not tested any services, appliances, equipment or facilities and nothing in these particulars should be deemed to be a statement that they are in good working order, or that the property is in good structural condition or otherwise. Any areas, measurements, floor plans or distances referred to are given as a guide only and are not precise. Purchasers must satisfy themselves by inspection or by otherwise regarding the items mentioned above and as to the correctness of each of the statements contained in these particulars. No person in the employment of Ashtons has any authority to make or give any representation or warranty whatsoever in relation to this property or these particulars nor enter into any contract relating to the property on behalf of the vendor.



Princess Drive  
, York  
YO26 5SY

Offers Over £185,000

 2  1

A fantastic two bedroom apartment located on the popular Princess Drive development known for its parks and green spaces. The property is ideal for those commuting with easy access to the outer ring road and also York Railway station. Local amenities on Acomb town street are just a short walk away, while well connected public transport provides easy access to the city centre.

A secure communal entrance and stairway leads to the front door of this impressive top floor apartment. The internal hallway provides access to all rooms which includes a storage cupboard and a hatch for access to a loft space. At the front of the apartment there is a generous living/dining room with modern laminate flooring, made private by the surrounding mature trees and natural greenery.

The apartment benefits from a separate fitted kitchen with a range of wall and base units for storage and plenty of worktop space around a newly fitted 1.5 sink. The internal accommodation is completed by two double bedrooms and a family bathroom with shower over bath.

There are also the advantages of electric heating and double glazing. The property has been modernised throughout and is ready to move straight into.

Externally the property benefits from a private off street parking space. The development also provides multiple visitors parking spaces and a secure bike store for residents.

Leasehold  
Length of lease- 125 years from 1 January 2004  
Ground rent £100pa  
Service charge - £270pcm  
Service charge review period - Annual (October).  
Council Tax Band - C

